

# WEC

WHOLESALE EQUIPMENT COMPANY

5355 DISTRIPLEX FARMS DRIVE  
 MEMPHIS, TN. 38141  
 PHONE: 901.366.5767 FAX: 901.366.0093  
<http://www.itswec.com>

## NEW SOLUTION 1695MKADA Series Built-in Combination Lock for Single Point Latch ADA Lockers



Patent Pending

ADA Compliant\*  
\*as defined on page 16

ADA Inspired

Uses same technology as automotive door lock systems

Wrap Around Latch™ Technology!

Enhanced security built-in combination lock - the best lock for single point latch lockers!

**FOR USE ON LOCKERS DESIGNED FOR 1695MKADA SERIES LOCKS**  
 Consult your locker manufacturer for correct match.

### EXCLUSIVE FEATURES

#### 3 Ways to Open Lock!

- **Change Key (for ADA student)**
  - Two keys provided with ADA keyheads
  - Key only opens one lock
- **Master Key (for supervisors)**
  - Each master key opens all 1695 locks in your system
  - Each master key system has approximately 400 key changes
- **Combination (for use like other combo locks in your system)**
  - 5 combinations built in for reuse year after year
  - Automatic combination reset once door is shut
- Allows flexibility of using locker for standard use or ADA use
  - Combination for standard use and change key for ADA use
- Same 1690 look helps mainstream ADA students
- Key code is visible inside keyhead
- Automatic slam shut with secure deadbolt locking



- Same concealed mounting and rugged metal case as the 1690 (Refer to page 5)
- New latch wraps around a latch plate offering the best and most secure single point latch engagement
- Designed to tolerate locker misalignment; easier installations and less adjustments for the life of the lock

#### Options

- Metal dial available to deter vandalism; order number 1695MKMDADA
- Customize with a color – five colors to choose from



### DIMENSIONS

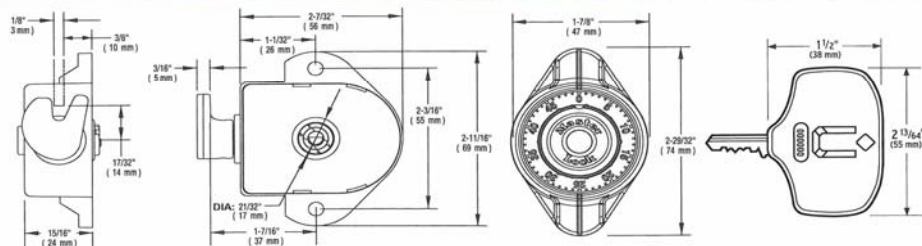

### SPECIFICATIONS

**Architectural Specifications:** Locks shall utilize a rotational operating deadbolt latch that locks by wrapping around a stationary latch plate or post. Once locked, the latch shall not be moveable until the lock is properly opened. Locks shall be both key operated and combination operated. Key operation shall use a 5 pin tumbler cylinder with individual and master keying capabilities. Locks shall have five (5) preset combinations. Locks shall have a random combination change pattern; no sequentially adjacent locks shall have the same combination change pattern. Locks shall be supplied with a printed Control Chart, containing the serial numbers and combinations. For optional one-piece metal dial specify Master Lock number 1695MKMDADA